

STONE

PARKWOOD GOLF CLUB

STONE



24 Ben Hogan Crescent Parkwood, QLD

6

1

6

4

## Once-in-a-Lifetime Opportunity - Extravagant Estate on Parkwood Golf Course

For the visionary buyer, this is a once-in-a-lifetime opportunity to own the largest estate on the prestigious Parkwood International Golf Course, an original mansion with limitless potential. Set on a sprawling 1,567sqm block with direct access to the golf course, this property is a blank canvas, awaiting transformation into the home of your dreams.

The scale and location of this estate provide an exceptional foundation for a world-class redesign. Imagine creating a bespoke residence that seamlessly blends luxury, style, and modern comforts, all while preserving the unmatched prestige of being part of Parkwood's most iconic address.

Features include:

- Six luxurious bedrooms, each with its own private ensuite
- Spacious living areas, including both formal and casual spaces

Price:

Contact Agent



**Ingrid Miller**

0459 226 283



**Aydan Mullin**

0412 490 406



**24 Ben Hogan Crescent**  
**PARKWOOD QLD**

6 Bed | 7 Bath | 4 Car | 1,567sqm Land

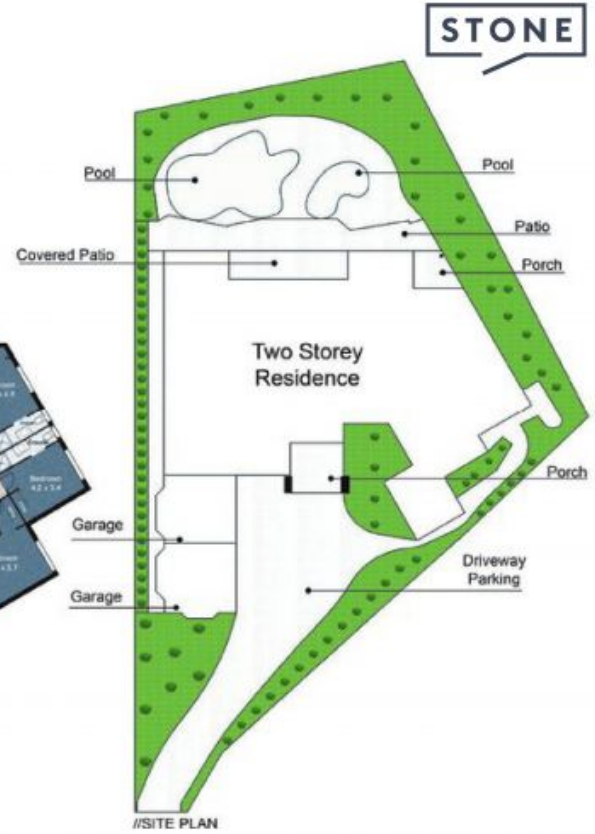

Whilst we have made every attempt to ensure the accuracy of the floor plan contained here, measurements are approximate, and no responsibility is taken for any errors, omissions, or misstatement. This plan is for illustrative purposes only.