



119 Kinchela Creek Right Bank Road Kinchela, NSW 4 2 6

Windermere: Luxe Rural Retreat with Kinchela Creek Frontage

Welcome to "Windermere", an exquisite rural estate on 52.24Ha (129.08Ac) of serene Kinchela Creek frontage, where spacious and luxurious living meets breathtaking views and the charm of country life.

This stunning 4 bedroom home is a true retreat, designed for those seeking tranquility, privacy, and endless possibilities across expansive paddocks, with Kinchela Creek access right on the doorstep. Experience the best of rural living, perfectly situated just minutes from the coast's best beaches and nearby amenities.

PROPERTY HIGHLIGHTS

- Expansive Land:
- Elegant 4-Bedroom Home:
- Outdoor Features:
 - Impressive infrastructure with two large machinery sheds, steel cattle yards, fenced pad...

Price: \$1,750,000
Council Rates: \$5,408.50/year (approx)



Josh Wicks
0448 637 509

119 Kinchela Creek Right Bank Road
Kinchela

STONE

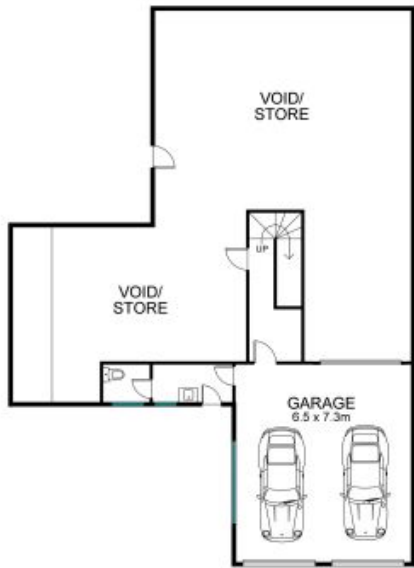

LOWER LEVEL



UPPER LEVEL



The site plan and floor plan are not to scale; measurement are indicative in meters. Bushes and trees are placed for illustration purposes. Plans should not be relied on. Interested parties should make and rely on their own inquiries. All other information provided has been collected from reliable sources but cannot be guaranteed for accuracy.