



40 Llantwit Road Woodbridge, TAS

4

2

4

WOODBIDGE HISTORY

'Coonawarra' is a remarkable property and boasts a prime location in the picturesque village of Woodbridge. This property is on the market for the first time since 1968.

Discover this unique offering - a generous, modern farmhouse set on 3.541 hectares of certified organic pastureland. 'Coonawarra' holds a captivating history, having served as a former doctor's surgery, witnessed the birth of many locals, and evolved into an apple orchard before transitioning into a thriving cattle farm, with the adjacent land.

The farmhouse has an enchanting ambiance with its wide corridors, lofty ceilings and classic period skirting boards evoking timeless charm. Every room showcases generous proportions, ensuring abundant comfort and refined elegance throughout.

...

This home is designed for cozy living, featuring double-glazed windows and insulation throughout, solar hot water, hydronic heating system, ensuring year-round comfort and energy s...

Price:

\$2,400,000



Wendy Wade

0418 561 538



Louise Wallace

0429 671 462

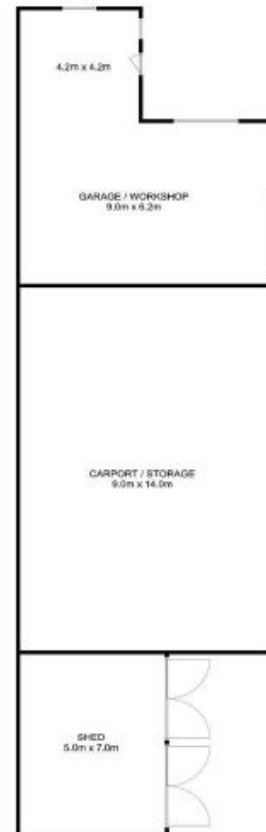

Total Approx. Floor Area : 290 sqm
Total Approx. Outbuilding Area : 250 sqm

All measurements are internal and approximate.
This plan is a sketch for illustration, not valuation.
Produced by Open2view.com