



17 Alcove Way Beveridge, VIC

4 2 2

Bright and Beautiful in a Quiet Alcove

Discover this stunning move in ready Carlisle family home nestled in the heart of Mandalay Estate, set perfectly on a peaceful street aptly named Alcove Way. With an inviting open plan design, enjoy natural light flooding two spacious living zones, ideal for relaxation and entertaining.

Features:

- 4 generous bedrooms, including a master suite
- 2 modern bathrooms with premium finishes
- Dual living spaces, offering flexibility for family life
- S fold sheer curtains and block out blinds
- Ducted Gas heating and evaporative cooling
- Aggregate concrete
- Landscaped gardens, automated sprinkler system
- Quiet no through road

Inspect: Saturday, 9th November 2024 1:30 - 2:00

Price: 675,000 - 735,000



Jenni Ter Haar

0438 130 473

17 Alcove Way, Beveridge
Beveridge



The floor plan is not to scale; measurements are indicative and in metres. All features included in this 3D plan are for inspiration purposes only. This is not an exact replica of the property or the position of exterior elements. Plans should not be relied on. Interested parties should make and rely on their own enquiries.

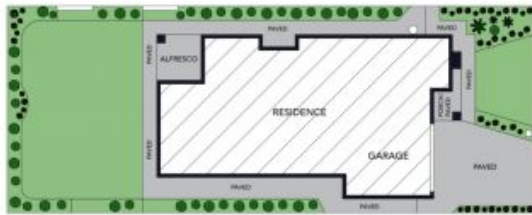

Site Plan



The site plan and floor plan are not to scale; measurements are indicative and in metres. Bushes and trees are placed for illustration purposes. Plans should not be relied on. Interested parties should make and rely on their own enquiries. All other information provided has been collected from reliable sources but cannot be guaranteed for accuracy.