



43 Melbourne Road Wadalba, NSW

4 2 2

### Immaculate, Renovated Family Home

Presenting the perfect opportunity to acquire this sensational renovated property, where all the hard work has been done for you. Simply move in and enjoy! Designed to embrace family lifestyle, this impressively proportioned four -bedroom home is well located in this sought after suburb.

Stunning in presentation and immaculate throughout, with added features such as custom-built barn doors and pendant lighting. Only minutes' walk to schools, supermarkets and Wadalba shopping village. Boasting two spacious living areas, side access and more, all positioned on a 486m2 fully fenced block.

- Recently renovations include feature lighting, painted throughout, new internal doors and landscaping
- Four spacious bedrooms with built-in wardrobes; the master suite features an ensuite and walk-in robe.
- Modern Kitchen with quality appliances and plenty of storage
- Additional separate lounge or media room provides versatile living options.
- Double garage with internal access

**Inspect:** Saturday, 9th November 2024 1:30 - 1:50

**Price:** Price Guide \$880,000



**Louise Barwick**

0450 560 478

43 Melbourne Rd, Wadalba NSW 2259

STONE



FLOOR PLAN

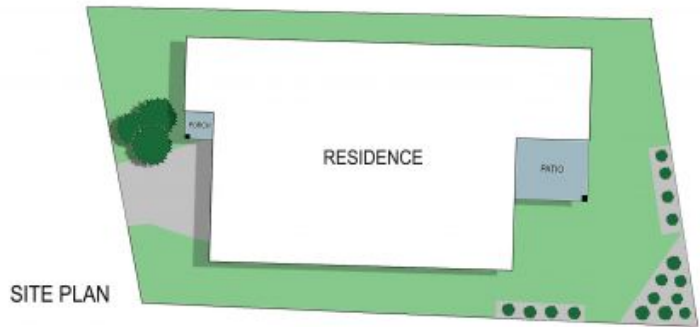

SITE PLAN

The Floor plan is not to scale; measurements are indicative and in metres. Plans should not be relied on. Interested parties should make and rely on their own enquiries. All other information provided has been collected from reliable sources but cannot be guaranteed for accuracy.