

2 Victoria Street Roseville, NSW

3

1

2

East side Art Deco gem with luxurious updates

Presenting an exquisite full brick Art Deco residence in a coveted east side location just 400m to rail. Reassuring in its elegance and privacy, surrounded by a blend of original character filled residences and new residences, all set in an ultra convenient locale.

- 400m to rail, 718sqm of north to rear land, 18.9m frontage, mature garden
- Custom renovated kitchen, soft close joinery, Caesarstone benchtops
- Five burner gas cooktop and extra-wide oven, integrated dishwasher
- Sumptuous formal lounge and media room, both open to garden terraces
- Formal dining room, de Gournay custom wallpaper, Murano glass chandelier
- Three huge bedrooms, elevated views, king-size main bedroom with balcony
- Luxurious full bathroom, marble features, heated floor, separate toilet
- Internal laundry with toilet has opportunity to create another bathroom

Inspect:

Saturday, 9th November 2024 11:30 - 12:00

Auction:

23/11/2024 03:00 pm

Price:

Auction 23rd Nov



Jill Henry

0416 493 555



Sahil Kotian

0434 172 588

2 Victoria Street
Roseville NSW 2069

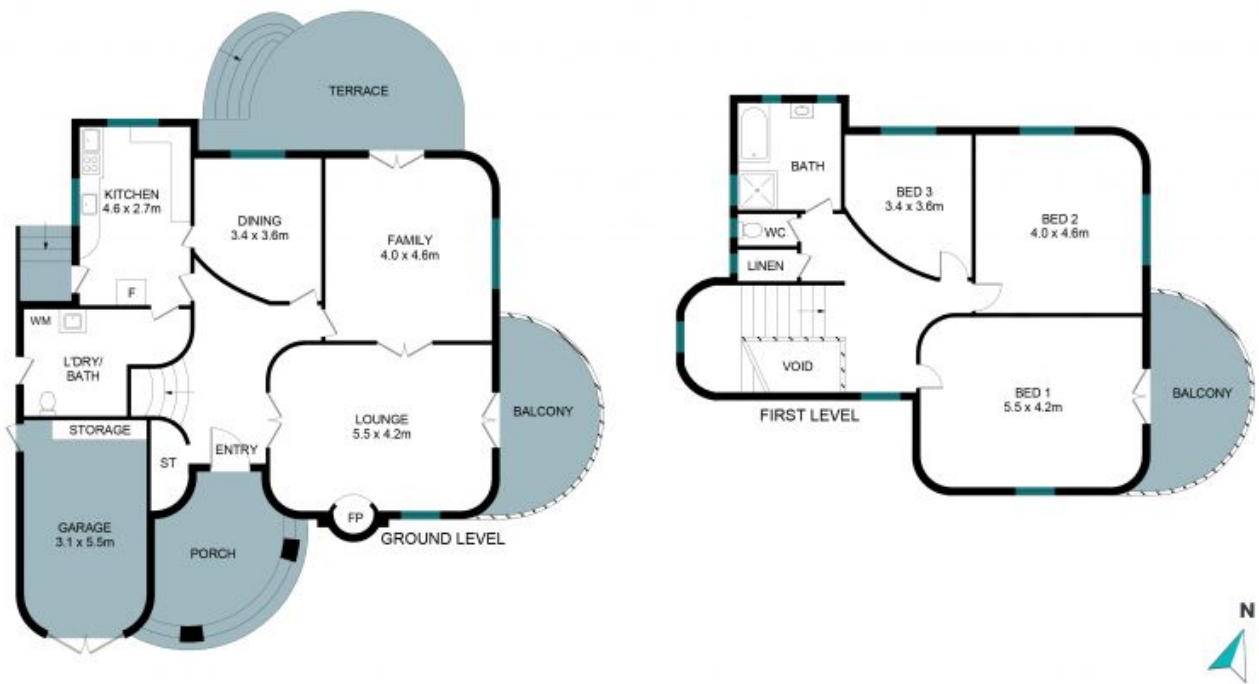

The site plan and floor plan are not to scale; measurements are indicative and in metres. Bushes and trees are placed for illustration purposes. Plans should not be relied on. Interested parties should make and rely on their own enquiries. All other information provided has been collected from reliable sources but cannot be guaranteed for accuracy.