

STONE

Lindfield Station
(200m)

Lindfield Village Green

2/8-10
Russell
Avenue



2/8-10 Russell Avenue Lindfield, NSW

3

2

2

Village convenience and renovated luxury in house-like haven.

Experience premier east side convenience and sophistication in this exquisite full brick townhouse, ideally situated in the manicured Olveston residences, just 200m to rail and village. Spanning approximately 190sqm on title, and offering versatile space, the home is an ideal retreat for those seeking a stylish start for their family or the serene luxury of a downsize.

Windows on all sides invite natural light into the heart of airy interiors that open to a north facing balcony. The modern Shaker kitchen features premium European appliances, while two luxuriously renovated bathrooms offer the comfort of heated floors. Don't miss out on this lifestyle opportunity.

- 190sqm on title, double brick townhouse, 200m to rail from garage entry
- One of only six in a private and gated complex of superb classic elegance
- Easy level stroll to the vibrant village caf? scene, IGA, and Harris Farm
- Lounge and adjoining dining, easily adapt dining to an additional bedroom

Inspect:
Auction:

Saturday, 9th November 2024 2:30 - 3:00
23/11/2024 10:00 am

Price:

Auction: Saturday 23rd November On-site



Patrick Haddad

0466 621 421



Steven Kourdis

0402 555 675

2/8-10 Russell Avenue
Lindfield

STONE

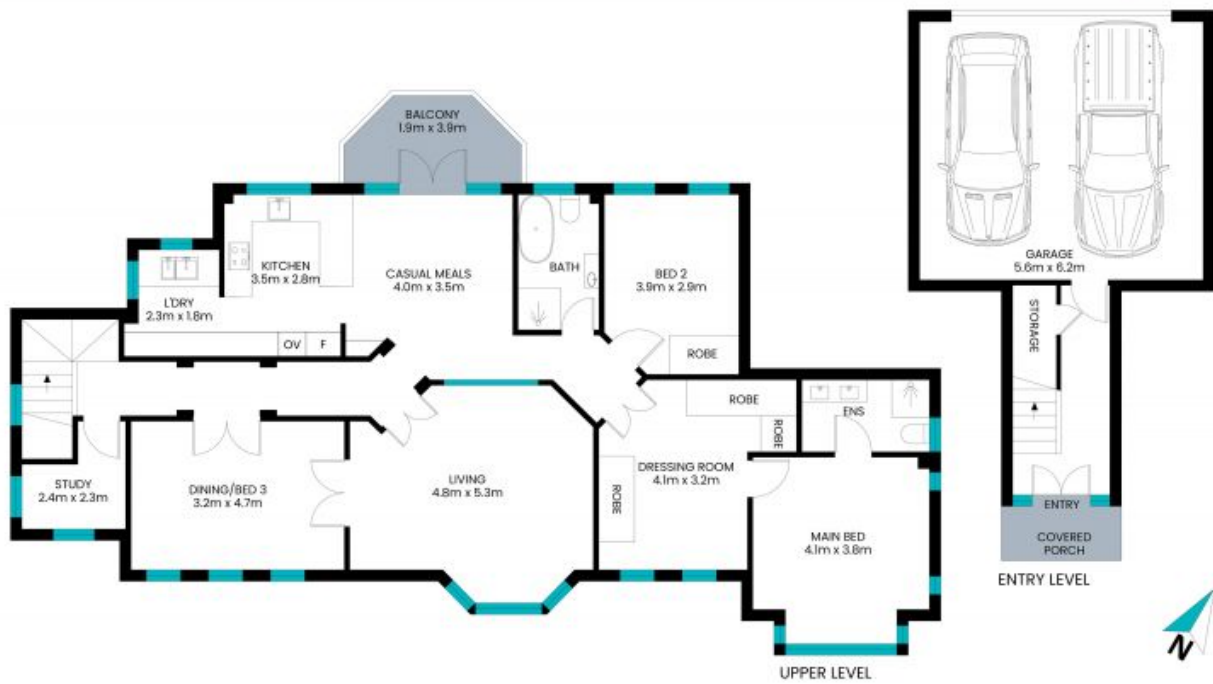

Internal area + balcony: 142m²
Total area on title: 190m²

The site plan and floor plan are not to scale; measurements are indicative and in meters. Bushes and trees are placed for illustration purposes. Plans should not be relied on. Interested parties should make and rely on their own enquiries. All other information provided has been collected from reliable sources but cannot be guaranteed for accuracy.