



11/666 Pacific Highway Killara, NSW

3

2

1

## Huge family sized stunner renovated for designer appeal

Find the family-sized space and stunning ready to enjoy contemporary comfort you've been looking for in this fully renovated double brick security apartment. Sheltered from the highway the level layout encompasses 153sqm approx. with generous open plan living and dining. Feeling like a private retreat, the sunroom flows to a lushly planted garden. All areas are appointed with abundant storage including three huge bedrooms. The renovated kitchen and two bathrooms, deliver five-star style and functionality. Great to live-in or invest, this stellar apartment is just 700m to rail and in Killara High zone.

- Ready to enjoy fully renovated double brick security apartment
- Family-sized generosity gives everyone plenty of space to relax
- Single level layout sheltered from the highway and opening to garden
- Living and dining adjoins a sunroom retreat perfect to work from home
- Renovated kitchen designed for abundant storage, integrated fridge + freezer
- Smeg induction cooktop, oven, dishwasher, microwave, stone benchtops
- Three vast bedrooms offer exceptional storage and an ensuite to main

**Auction:**

30/11/2024 03:00 pm

**Price:**

Auction - Saturday 30th November



**Ryan Woo**

0410 884 680



**Andrew Braid**

0404 979 597

11/666 Pacific Highway,  
Killara

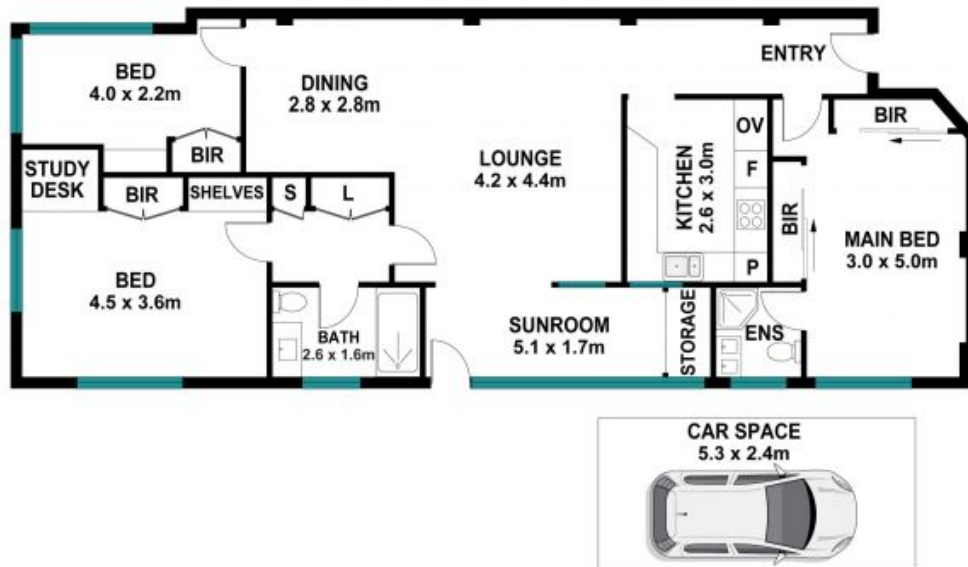

The site plan and floor plan are not to scale; measurements are indicative and in metres. Bushes and trees are placed for illustration purposes. Plans should not be relied on. Interested parties should make and rely on their own enquiries. All other information provided has been collected from reliable sources but cannot be guaranteed for accuracy.