

6/2-6 Lydbrook Street Westmead, NSW

2

2

1

2 bedroom apartment in a convenient location

Discover the perfect blend of convenience, comfort, and modern living in this beautifully presented 2-bedroom apartment. Nestled in the heart of Westmead, this property offers an exceptional lifestyle opportunity for first-home buyers, downsizers, or savvy investors.

Key Features:

Kitchen: quality stainless steel appliances, ample storage, and sleek finishes
Two Generous Bedrooms: Both with built-in wardrobes, master with an ensuite
Stylish Bathrooms: Contemporary design with quality fittings.
Secure Parking: Includes a designated parking space and additional storage

Price:

Contact Agent



Natasha Chand

0414 687 418

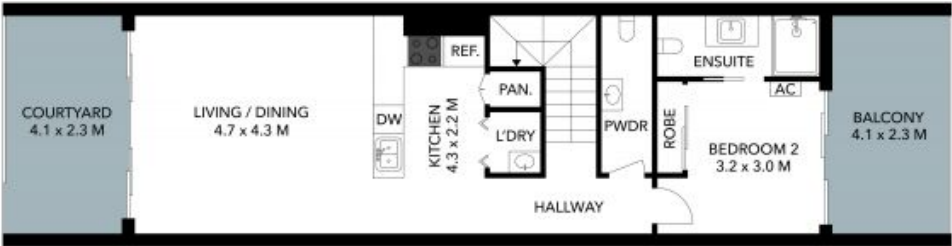

Ground Floor



Basement



First Floor



The floor plan is not to scale; measurements are indicative and in metres. Exterior elements are not in position. Plans should not be relied on. Interested parties should make and rely on their own enquiries. All other information provided has been collected from reliable sources but cannot be guaranteed for accuracy.

6/2-6 Lydbrook Street
Westmead



Ground Floor



Basement



First Floor



The floor plan is not to scale; measurements are indicative and in metres. All features included in this 3D plan are for inspiration purposes only. This is not an exact replica of the property or the position of exterior elements. Plans should not be relied on. Interested parties should make and rely on their own enquiries.