



58 Day Road Cheltenham, NSW



Scenic family sanctuary with unmatched tranquility in premium school catchments

Set high with spectacular valley views at the end of a whisper-quiet street, this immaculate, picturesque residence offers incredible privacy and abundant natural light, with botanical outlooks from every room. Unrivalled in indoor-outdoor flow, it's a peaceful haven to stroll to Cheltenham Station and in the highly sought-after catchments for Beecroft Public, Cheltenham Girls, Epping Boys, and Pennant Hills High Schools.

- Aspirational family environment with quality finishes on a 1,258sqm parcel
- Ready to move in and enjoy, with fresh paint, stylish blackbutt timber floors
- Expansive semi-covered wraparound deck with tranquil front and rear vistas
- Promising effortless entertaining with two living spaces connecting to deck
- Chic kitchen with gas cooktop, all-Miele appliances, and electric drawers
- Four spacious bedrooms, three carpeted and featuring built-in wardrobes
- Master has dual BIRs, skylight with auto blind, ensuite with heated floors
- Elegant bathroom with soaking bathtub, corner shower, separate entry toilet

Inspect: Saturday, 19th October 2024 1:00 - 1:30

Sunday, 20th October 2024 2:00 - 2:20

Auction: 09/11/2024 05:15 pm

Price: Premiere Showing

Council Rates: \$687.00 p/q

Water Rates: \$171.41 p/q



Kevin Dearlove

0403 338 302



Leo Li

0404 917 188

58 Day Road, Cheltenham

4 2 3 1258m²

STONE

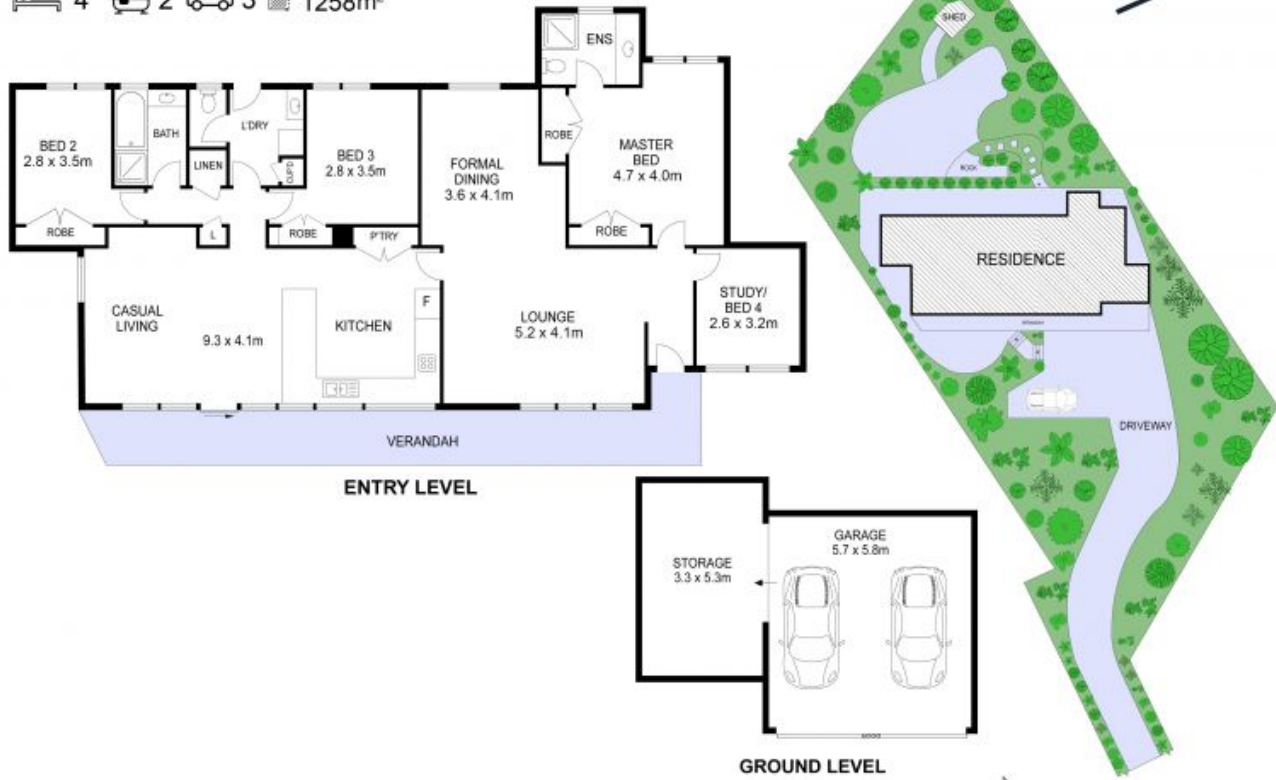

THIS IS AN ARTIST'S IMPRESSION - ALL DIMENSIONS, LAYOUTS AND TREES ARE APPROXIMATE
ALL INTERESTED PARTIES SHOULD MAKE AND RELY ON THEIR OWN ENQUIRIES

