



36 Abingdon Road Roseville, NSW



Readymade family lifestyle brims with renovated appeal

- Ready for immediate enjoyment on 866sqm approx. of non-conservation land
- Light and spacious throughout, large format tiles, white interior palette
- Open living room with modern gas flame fireplace and plenty of north sunshine
- Versatile dining and family sunroom opens to the leafy serenity of the deck
- Cutting-edge kitchen with engineered stone benchtops, island, meals area
- Bosch gas cooktop, wok burner, oven, dishwasher, ducted rangehood
- Four large bedrooms, modern built-in robes, super-sized master, luxe ensuite
- Luxurious bathrooms, concealed cisterns, illuminated mirrors, vessel basins

Inspect:

Saturday, 19th October 2024 1:45 - 2:15

Auction:

09/11/2024 03:00 pm

Price:

Auction



Jill Henry

0416 493 555



Sahil Kotian

0434 172 588

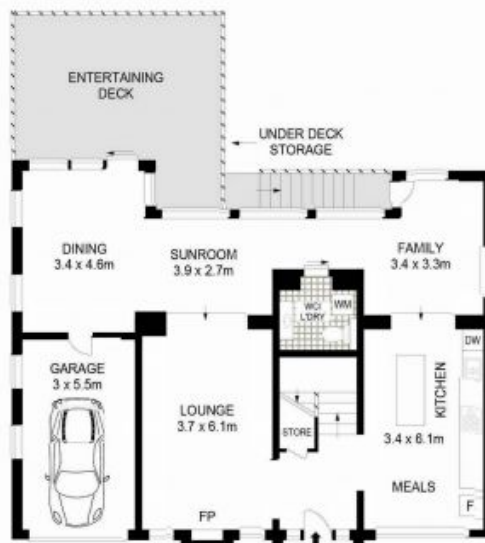

GROUND FLOOR



FIRST FLOOR



The site plan and floor plan are not to scale, measurements are indicative and in metres. Bushes and trees are placed for illustration purposes. Plans should not be relied on. Interested parties should make and rely on their own enquiries. All other information provided has been collected from reliable sources cannot be guaranteed for accuracy.