

28 Prairie Avenue Maudsland, QLD



## A Perfect Family Retreat for Quality Time and Carefree Summer Days

Welcome to 28 Prairie Avenue, Maudsland-a charming 4-bedroom house that offers an ideal first-home opportunity, exuding style and exceptional value. With the property now vacant, bond-cleaned, and ready for immediate occupancy, the sellers are eager to secure an offer before Christmas.

This stunning residence, thoughtfully designed, is filled with delightful surprises and is perfect for celebrating the festive season. Located within the highly sought-after Riverstone Crossing community, you'll enjoy an enviable lifestyle just 10 minutes from the freeway, providing easy access to Brisbane CBD, top educational facilities, Westfield Helensvale shopping, dining options, and public transport.

Key Features:

...

Comfort Throughout the Year: The main family and dining area is equipped with split-system...

**Inspect:**

Saturday, 19th October 2024 1:00 - 1:30  
Sunday, 20th October 2024 10:00 - 10:30

**Price:**

Contact Agent



**Andrew Colley**

0488 217 803

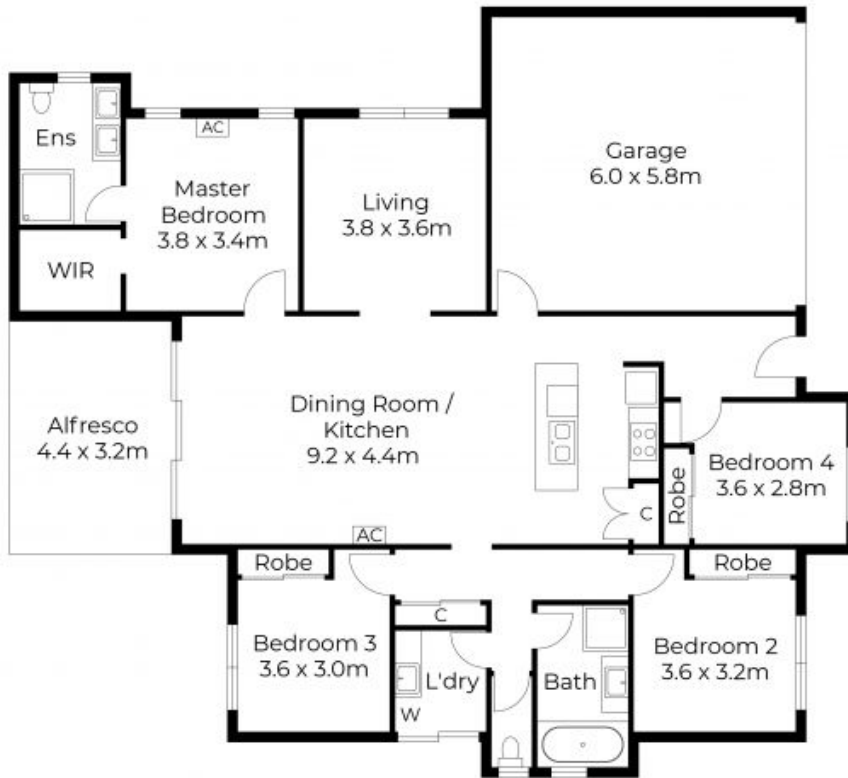

Floor plans and site plans are for illustrative purposes only. They are not part of any legal document or title and are subject to errors, omission, and inaccuracies. Whilst every attempt has been made to ensure the accuracy of this plan, measurements of doors, windows, rooms, cupboards etc are approximate only.

APPROXIMATE AREA  
 LIVING AREA : 137m<sup>2</sup>  
 TOTAL AREA : 186m<sup>2</sup>



Floor plans and site plans are for illustrative purposes only. They are not part of any legal document or title and are subject to errors, omission, and inaccuracies. Whilst every attempt has been made to ensure the accuracy of this plan, measurements of doors, windows, rooms, cupboards etc are approximate only.

APPROXIMATE AREA  
LIVING AREA : 134 m<sup>2</sup>  
TOTAL AREA : 185 m<sup>2</sup>