



40 Peacock Street Seaforth, NSW 4 2 2

### Character with perfect northerly aspect and views

Hidden from street view on a large 720sqm block amid established, landscaped gardens, this full brick character bungalow combines classic period detail with modern appointments, creating a warm and inviting family home with options to grow and enhance. Capturing a perfect rear-to-north aspect delivering abundant all-day natural light, this charming home enjoys elevated leafy district views and ocean glimpses that make outdoor living and entertaining an absolute delight.

- Open concept living and dining extending to a covered entertaining terrace with elevated views to the ocean
- Contemporary Caesarstone kitchen with gas cooktop, dishwasher and breakfast bar
- Expansive covered front deck provides an additional outdoor living option
- Bright master bedroom with large windows, ceiling fan, built-in robes, and ensuite
- Flexible floorplan with a study or potential fifth bedroom
- Lower-level living space flows to a spacious north-facing deck, perfect for entertaining

**Inspect:** Saturday, 19th October 2024 10:30 - 11:00  
**Auction:** 29/10/2024 06:00 pm

**Price:** Auction Guide \$3,300,000



**Maria Cassarino**

0411 818 093



**Lauren Sudol**

0438 138 675

40 Peacock Street  
Seaforth

STONE



Internal Living: 205 sqm  
External Living: 116 sqm  
Total Living Area: 321 sqm

LOWER LEVEL

UPPER LEVEL



The floor plan is not to scale; measurements are indicative and in metres. All features included in this 3D plan are for inspiration purposes only. This is not an exact replica of the property or the position of exterior elements. Plans should not be relied on. Interested parties should make and rely on their own enquiries.

40 Peacock Street  
Seaforth

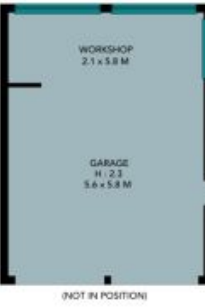
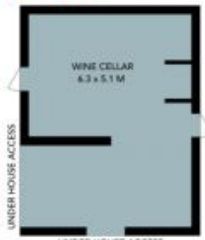

Internal Living: 205 sqm  
External Living: 116 sqm  
Total Living Area: 321 sqm



LOWER LEVEL



UPPER LEVEL

STONE



The floor plan is not to scale, measurements are indicative and in metres. Exterior elements are not in position. Plans should not be relied on, interested parties should make and rely on their own enquiries. All other information provided has been collected from reliable sources but cannot be guaranteed for accuracy.