



9D Lyne Road Cheltenham, NSW



Picturesque family oasis in Cheltenham Girls catchment

Discover the instant allure of this inviting family home, boasting a stunning manicured garden frontage that sets the tone for the rest of the property. Cherished by the sole owners for 25 years, the inviting, comfortable atmosphere is underpinned by spacious, sunlit interiors and a thoughtful floorplan. It's zoned for Epping Heights Public, Cheltenham Girls, and Epping Boys High.

- Double-door, stained glass entry revealing a sun-filled foyer and staircase
- Sumptuous formal living seamlessly flowing through to a formal dining zone
- Open-plan family and dining domain effortlessly connects with outdoors
- Gourmet kitchen with a breakfast bar, spacious pantry, and tiled splashback
- Grand master suite with walk-in, ensuite with corner bath and double vanity
- Three more carpeted bedrooms with broad windows; built-in robes to all
- Flexible ground-floor study or home office, generously sized for comfort
- Family bathroom with a corner soaking bath and separate shower, separate WC

Price: Auction
Council Rates: \$592.30 p/q



Kevin Dearlove

0403 338 302



Brian Kong

0435 333 383

9D Lyne Road, Cheltenham

4 2 2 2 601.5m²

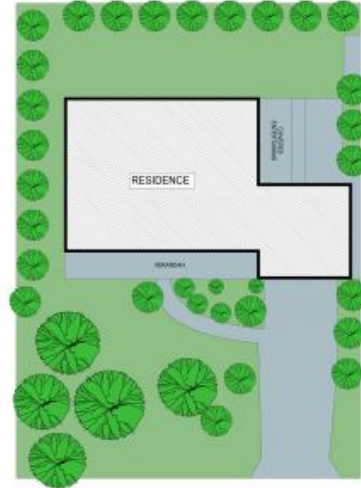

THIS IS AN ARTIST'S IMPRESSION - ALL DIMENSIONS, LAYOUTS AND TREES ARE APPROXIMATE
ALL INTERESTED PARTIES SHOULD MAKE AND RELY ON THEIR OWN ENQUIRIES

