



81 Corinth Road Heathcote, NSW



Expansive family living and sweeping bush views

Breathtaking National Park views and spacious interiors shine in this well-positioned family home. Featuring a generous family/rumpus room with space for a home office, plus a large upstairs main living with a relaxing balcony, it's versatility at its finest. An open plan dining and kitchen, plus an expansive outdoor entertaining area, make this the ideal entertainer and family-friendly abode.

- High ceilings, light-filled main living w/balcony, study nook and gas connection
- Versatile second living area with scope for a home office or fourth bedroom
- Three bedrooms with built-in storage, renovated main bathroom w/bathtub
- Open plan kitchen and dining with seamless outdoor flow, floating timber floors
- Stylish kitchen w/six burner gas stove, 900mm oven, dishwasher, stone benches
- Oversized paved entertaining area, second entertaining deck, tiered backyard
- North facing front aspect, undercover parking with internal access and storage
- Ideal location just minutes from Heathcote train station, shops and schools

Inspect: Saturday, 21st September 2024 11:00 - 11:30

Auction: 08/10/2024 05:15 pm

Price: Auction unless sold prior

Council Rates: \$387.50 p/q

Water Rates: \$172.79 p/q



Rhys Christofa

0415 684 877



Brayden Watson

0415 122 733



Ground Floor



First Floor

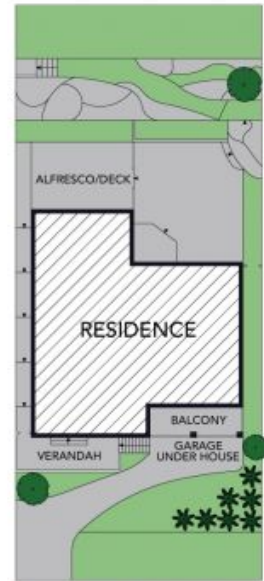

Site Plan



The site plan and floor plan are not to scale; measurements are indicative and in metres. Bushes and trees are placed for illustration purposes. Plans should not be relied on. Interested parties should make and rely on their own enquiries. All other information provided has been collected from reliable sources but cannot be guaranteed for accuracy.

81 Corinth Road
Heathcote

STONE



Ground Floor



First Floor



The floor plan is not to scale; measurements are indicative and in metres. All features included in this 3D plan are for inspiration purposes only. This is not an exact replica of the property or the position of exterior elements. Plans should not be relied on. Interested parties should make and rely on their own enquiries.