



510/55 Harbour Street Mosman, NSW



Executive Living

Capturing the essence of contemporary luxury and open space with a clever dual-level design, this inviting apartment offers a cosmopolitan lifestyle.

Upon entry, you're greeted by an uplifting sense of natural light and blue skies. The open plan living area blends with a stone bench kitchen and gas cooking, and seamlessly extends to a tiled balcony.

The one-bedroom haven is perfect for an executive, couple or investors seeking a turn-key opportunity in an upmarket pocket of Mosman.

Located within the sought after 'Harbour Vista' development, just head downstairs to indulge in an array of cafes, boutique shops, top restaurants, gyms, salons, transport and so much more - all within a stone's throw of your front door.

- Stylish dual-level design is light-filled and airy
- Stone finished kitchen with gas appliances

Inspect:

Saturday, 21st September 2024 11:00 - 11:30

Price:

Contact Agent Marize Bellomo



Marize Bellomo

0414 972 203



Alanna Tohme

0450 862 088

510/55 Harbour Street
Mosman



Level One

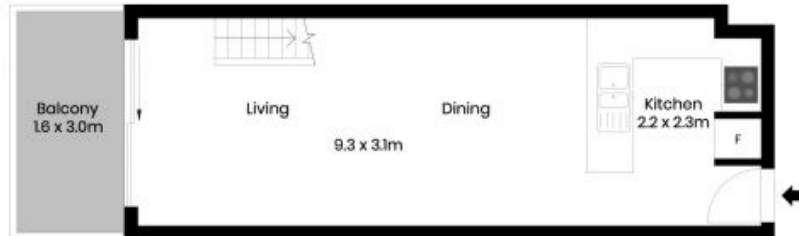

Entry Level

Secure Car Space
(Not in Position)

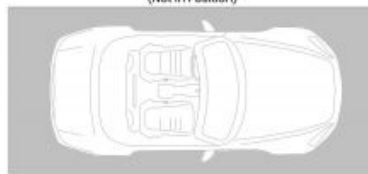

The site plan and floor plan are not to scale; measurements are indicative and in metres. Bushes and trees are placed for illustration purposes. Plans should not be relied on. Interested parties should make and rely on their own enquiries. All other information provided has been collected from reliable sources but cannot be guaranteed for accuracy.