



25 Pamela Drive Bray Park, QLD



Spacious Family Home Plus Pool

This charming 4-bedroom house on Pamela Drive offers a perfect blend of comfort and convenience. This well-maintained home features two modern bathrooms, a double carport, plus the potential for an additional 2 parking spaces in the original garage. The property is fully fenced, ensuring privacy and security for your family.

The residence is equipped with essential modern amenities including ducted cooling and heating, solar panels, and built-in robes.

Enjoy a seamless indoor-outdoor living experience with a spacious outdoor entertaining area and a stunning inground pool. Whether you're hosting a summer barbecue or enjoying a quiet evening by the pool, this home caters to all your leisure needs.

...
Property Features...

- 4 Bedrooms
- 4 Built Ins

Price: Offers Over \$1,025,000
Council Rates: \$515.00 p/q
Water Rates: \$435.00 p/q



John Ward

0427 090 968



Sue Ward

0427 073 434

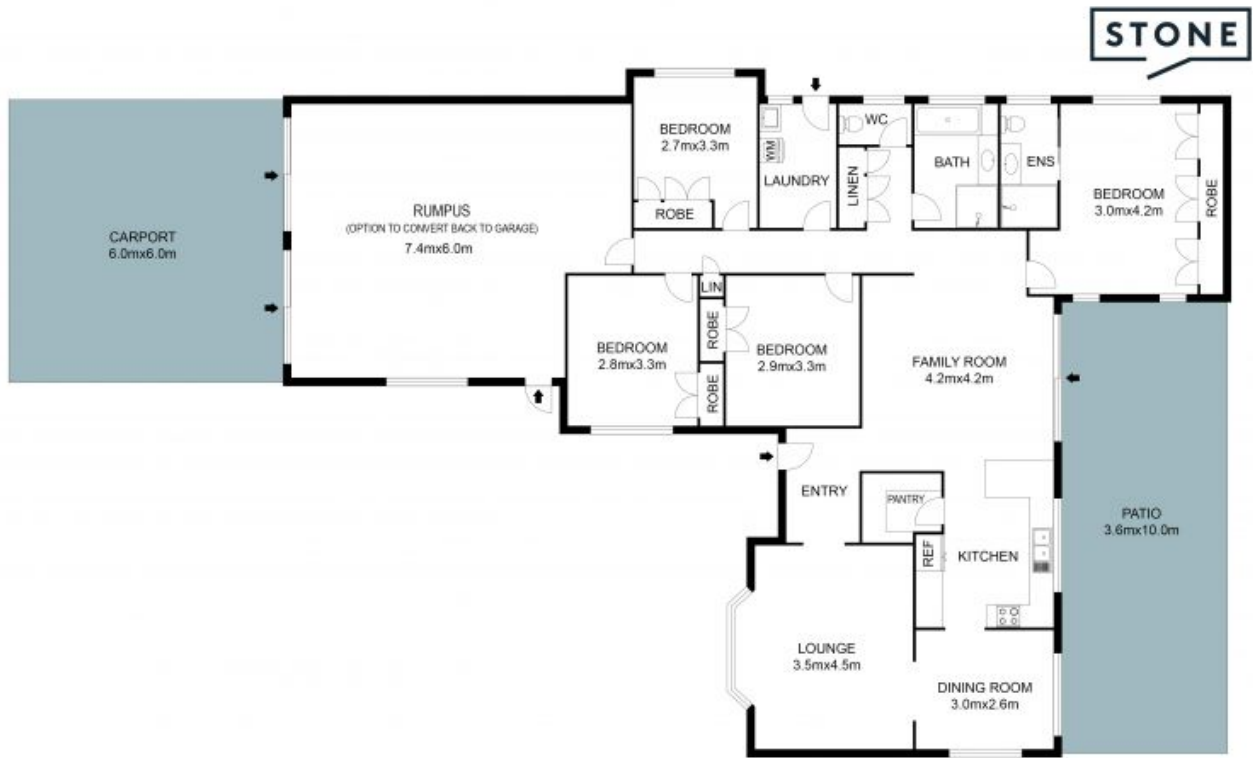

Floor Plan

The Floor plan is not to scale; measurements are indicative and in metres. Plans should not be relied on. Interested parties should make and rely on their own enquiries. All other information provided has been collected from reliable sources but cannot be guaranteed for accuracy.