



5 Shaftesbury Avenue West Wollongong, NSW

3 

1 

1 

Charming family friendly living

Welcome to your dream home in the heart of West Wollongong. This enchanting three bedroom home offers the charm and comfort of a tranquil neighbourhood. You will appreciate its prime city fringe setting, positioning you approx. 1.2 km from The Illawarra Grammar School, 650m from Figtree Grove shopping centre and 90m from the bus stop on London Drive, conveniently connecting you to the University of Wollongong, Wollongong CBD and local beaches. This delightful property is more than just a home; it's a lifestyle opportunity. Don't miss the chance to make this charming residence yours.

- Polished Cyprus pine flooring will lead you into the seamlessly connected living and dining area, with large windows that flood the space with natural light, creating a perfect space for both relaxing and entertaining
- Well-appointed kitchen features plenty of bench space, ample storage and timeless charm
- Three generously sized bedrooms, two with built-in wardrobes
- Generous storage space located under the house with easy access from backyard

Inspect:

Saturday, 21st September 2024 12:30 - 1:00

Price:

Price Guide \$959,000



Raffaele Di Candia

0451 552 861



Matthew Kasbarian

0432 521 051

5 Shaftesbury Avenue
West Wollongong

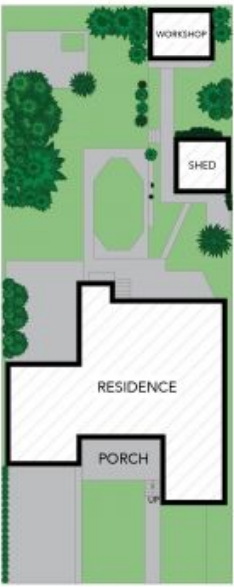
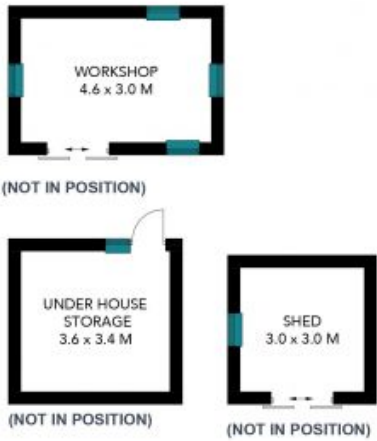

Site Plan



The site plan and floor plan are not to scale; measurements are indicative and in metres. Bushes and trees are placed for illustration purposes. Plans should not be relied on. Interested parties should make and rely on their own enquiries. All other information provided has been collected from reliable sources but cannot be guaranteed for accuracy.