



48/120 Thynne Street Bruce, ACT

2

1

2

Comfortable And Convenient Urban Lifestyle In Central Belconnen.

Open-home access off Kentish Lane

Embrace a comfortable and convenient urban lifestyle in this contemporary two-bedroom apartment situated in the Hub complex in the heart of Bruce.

Featuring an open-plan lounge and dining area and a practical floorplan, this home offers a flexible space for easy day-to-day living. With a North-west facing balcony, this design encourages a seamless flow of natural light, creating a welcoming atmosphere perfect for winding down after a busy day.

...
Features Overview:...

- North-west facing
- Second floor apartment
- Single level floorplan
- Located a short drive into Belconnen and Jamison town centres and surrounding regions fo...

Inspect: Saturday, 21st September 2024 1:30 - 2:00

Price: \$465,000+



Sam Dyne

0488 689 525

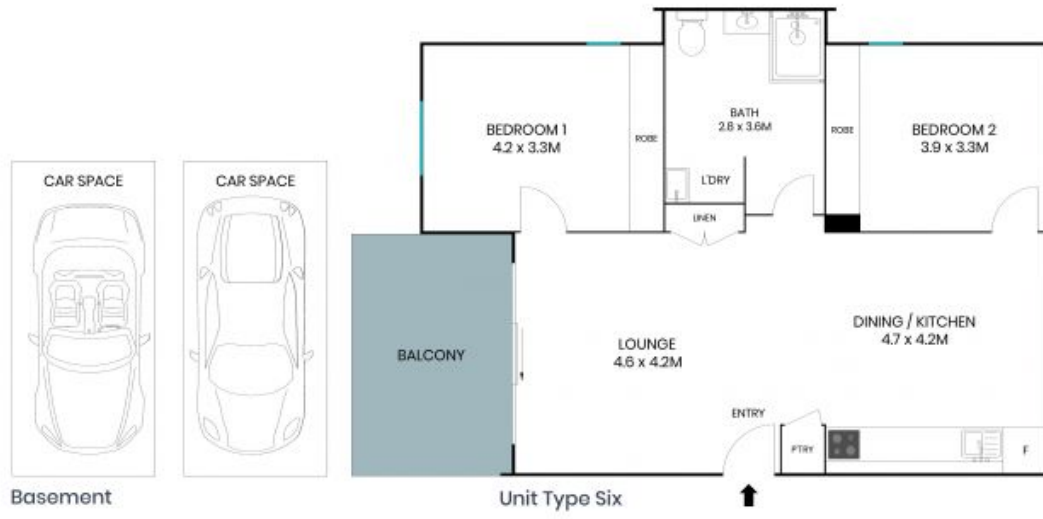

The site plan and floor plan are not to scale; measurements are indicative and in metres. Bushes and trees are placed for illustration purposes. Plans should not be relied on. Interested parties should make and rely on their own enquiries. All other information provided has been collected from reliable sources but cannot be guaranteed for accuracy.

48/120 Thynne Street
Bruce



Basement



Unit Type Six



The floor plan is not to scale; measurements are indicative and in metres. All features included in this 3D plan are for inspiration purposes only. This is not an exact replica of the property or the position of exterior elements. Plans should not be relied on. Interested parties should make and rely on their own enquiries.