



84 Ellery Parade Seaforth, NSW



## Elegant entertainer with north facing aspect and views

Immaculately maintained and well-appointed with quality modern finishes throughout, this exclusive Torrens Title attached residence offers house-like living combined with townhome convenience in a blue-ribbon Seaforth setting featuring city skyline and Middle Harbour views. Enjoying a sun-drenched North-to-rear aspect with bright, spacious interiors and highly-desirable indoor/outdoor flow to both front and rear, this appealing home presents an ideal opportunity for empty-nesters, executives and families looking for low maintenance living in a lifestyle location.

- Practical floorplan with three separate living spaces, including a substantial rumpus/games room or teen retreat
- Elegant formal living with cosy gas fireplace, flowing out onto substantial part-covered entertaining terrace with water and city skyline views
- Versatile separate dining room or potential home office
- Modern kitchen with granite benchtops and breakfast bar plus European appliances including Smeg gas cooktop

**Price:** Auction Guide \$3,000,000

**Council Rates:** \$660.00 p/q

**Water Rates:** \$171.00 p/q



**Maria Cassarino**

0411 818 093



**Lauren Sudol**

0438 138 675



84 Ellery Parade  
Seaforth



Internal Living: 223 sqm  
External Living: 89 sqm  
Total Living Area: 312 sqm



Lower Level



Entry Level



Upper Level



The floor plan is not to scale; measurements are indicative and in metres. All features included in this 3D plan are for inspiration purposes only.  
This is not an exact replica of the property or the position of exterior elements. Plans should not be relied on. Interested parties should make and rely on their own enquiries.

84 Ellery Parade  
Seaforth

STONE

Internal Living: 223 sqm  
External Living: 89 sqm  
Total Living Area: 312 sqm

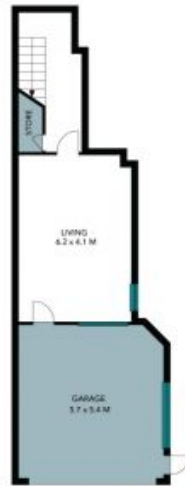

Lower Level



Entry Level



Upper Level



Site Plan



The site plan and floor plan are not to scale; measurements are indicative and in metres. Bushes and trees are placed for illustration purposes. Plans should not be relied on. Interested parties should make and rely on their own enquiries. All other information provided has been collected from reliable sources but cannot be guaranteed for accuracy.