

5 Napier Crescent North Ryde, NSW

6 3 2

Renovated modern stylish home on an expansive block

Wrapped in natural light this impressively scaled six-bedroom home is brimming in size with approx 350 Sqm of build area upon a child-friendly 714.5 Sqm block at located at the top of a quiet cul-de-sac. With a versatile layout perfect for large and extended families to entertain.

The large kitchen features a functional space with a built-in breakfast bar and is the heart of the home. It's a welcoming place for the family to enjoy casual meals together and relax or entertain with multiple living areas inside and out. The home features 6 bedrooms all large in size with the master featuring a well-sized ensuite along with a walk-in robe.

The home is embraced by landscaped gardens, a child-friendly sunlit rear, and side yard, low-maintenance pool complete with a generous front yard with side access. Location wise it is ideally positioned for easy access to Macquarie Shopping Centre, Business Park, university, sought-after schools, and city transport.

Price: Deposit Taken
Available Date: 27/07/2024



Robert Wu
0413 786 346



Stone North Ryde
02 8875 7845
Property Management



GROUND FLOOR

INTERNAL AREA: 349m²
 LAND SIZE: 714.5m²



FIRST FLOOR

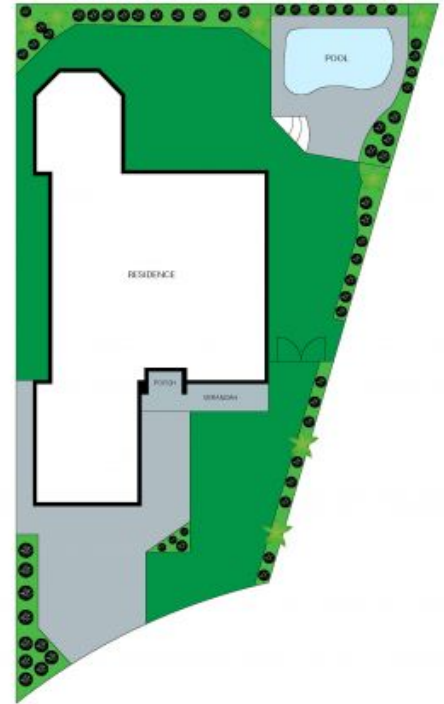

SITE PLAN

The floor plan is not to scale, measurements are indicative and in metres. Detail elements are not in position. Plans should not be relied on. Interested parties should make and rely on their own enquiries.

5 Napier Crescent, North Ryde

