



20501/2b Figtree Drive Sydney Olympic Park, NSW

2

2

1

Wonderful layout with park and city views

This is the best position in Mirvac's signature "Scarlett" building with total privacy. The apartment enjoys expansive views across extensive parklands to the CBD, Sydney Harbour Bridge and North Sydney.

- * 2 bedrooms, 2 bathrooms, security car parking
- * best building and best position in building
- * generous open plan living flows to a large, covered balcony
- * separate zones for bedrooms provides excellent privacy
- * integrated kitchen with stone benches
- * access to gym, BBQ area, community spaces and gardens
- * stroll Metro (under construction), ANZ Stadium, Bicentennial Park

ADDITIONAL FEATURES: full separation of bedrooms, video intercom, ducted air-conditioning, gas cooking, dishwasher, generous separate storage

OUTGOINGS

Strata Levies \$1,244 pq

Inspect:

Saturday, 21st September 2024 2:45 - 3:15

Price: \$1,000,000

Council Rates: \$316.00 p/q

Water Rates: \$180.00 p/q

Strata Rates: \$1,244.00 p/q



Michael Chant

0414 543 216



Jacinta Walsh

0422 881 128

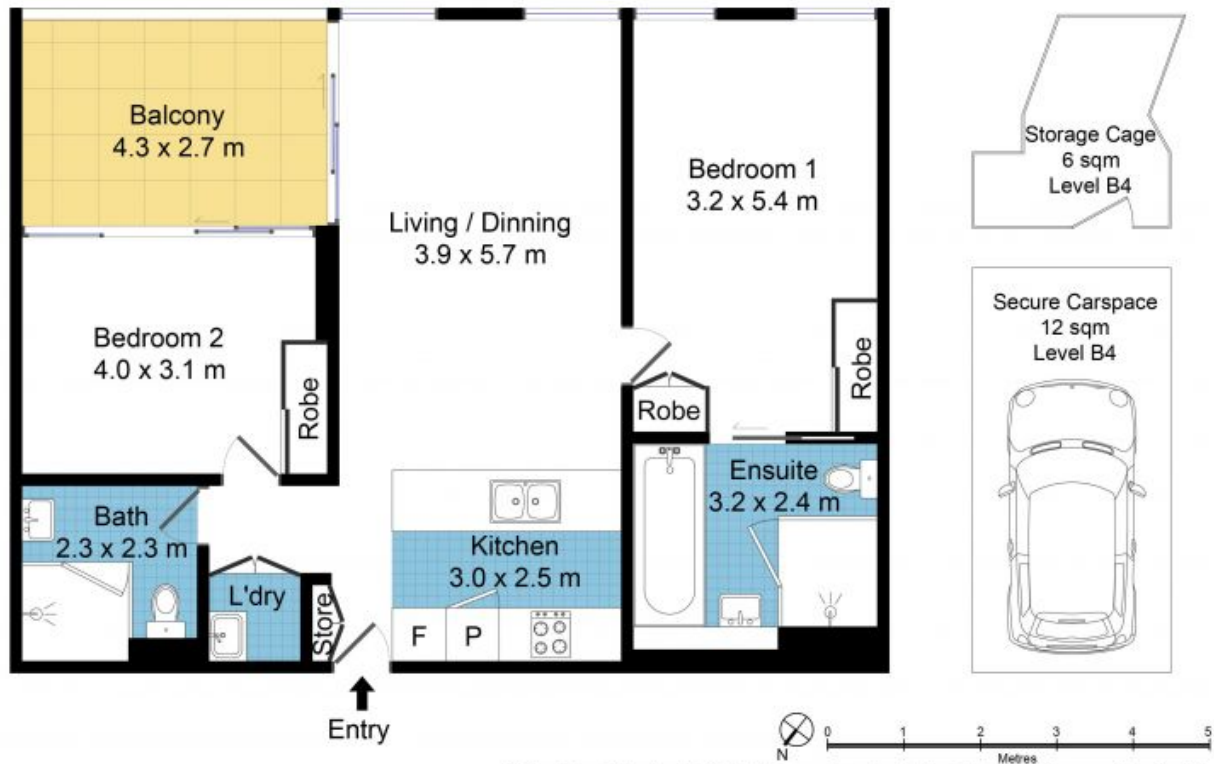

Disclaimer: Plans are indicative only and should be checked by the prospective purchaser. The information herein is gathered from sources we believe to be reliable.

Unit 20501, 2B Figtree Drive, Sydney Olympic Park