



18/8 Victoria Parade Manly, NSW

2

1

Art Deco gem seconds between Manly Beach and Sydney Harbour

'Rotorua' is positioned in one of the most tightly held locations in Manly. With the beach and harbour at either end of the street whilst on the cusp of Manly village, this location is simply unbeatable. Recently renovated, this cosy apartment, peacefully located at the rear of the block blends vintage charm with modern enhancements in an art deco block.

- Beautiful high ceilings with art deco cornices, restored timber flooring, designer lighting, fixtures and fittings
- Sunlit spacious bedrooms framed by palm trees
- Both bedrooms feature custom built-in cabinetry, pristine carpet and new remote controlled fans
- Bright open living room with display fireplace, dining area and northeast aspect
- Sizeable gas kitchen with laundry facility, stainless steel appliances and the potential to be opened to the living room (STA)
- Recently renovated bathroom with gas hot water

Price:

Contact Agent



Catherine Wilson

0421 966 570

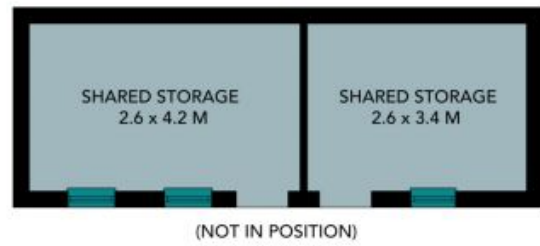

18/8 Victoria Parade
Manly

STONE

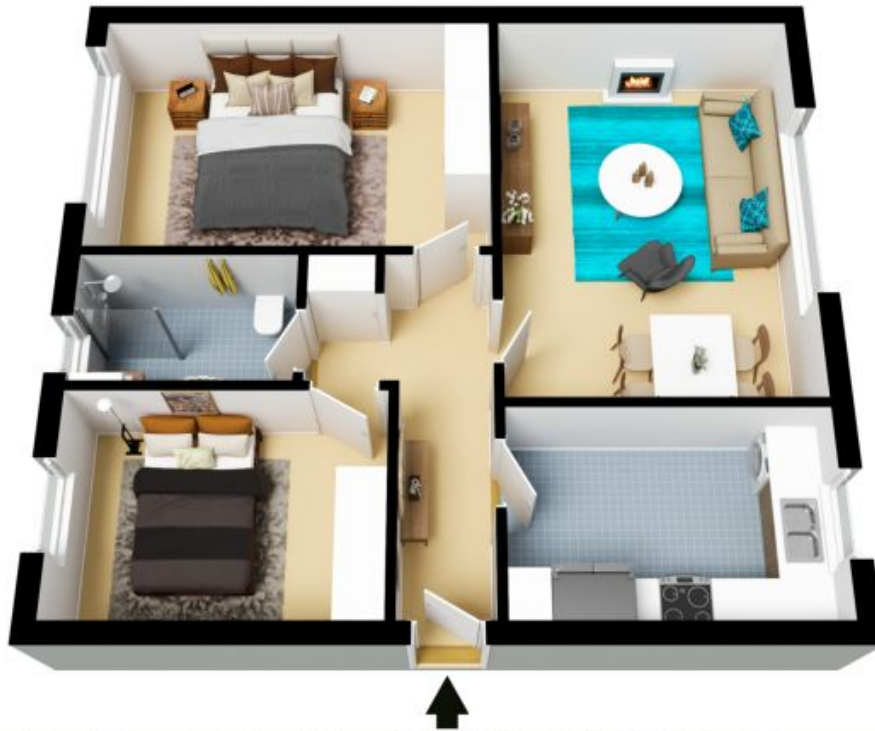

The floor plan is not to scale; measurements are indicative and in metres. All features included in this 3D plan are for inspiration purposes only. This is not an exact replica of the property or the position of exterior elements. Plans should not be relied on. Interested parties should make and rely on their own enquiries.