



304/132 Epsom Road Zetland, NSW



## North Aspect

Experience luxurious living with this north-facing, third-floor apartment in the nearly-new 'Paragon' building. Designed by Turner and Associates, this residence boasts a meticulously planned and spacious layout, complete with premium features. Perfect for first-time buyers or investors, it is ideally located within walking distance to East Village, public transport, and local parks.

- Sunlit living and dining area flowing to balcony
- Contemporary gas fitted kitchen with large island
- Generously sized undercover balcony featuring caged shelving/storage
- Large bedroom with mirrored wardrobes and balcony access
- Acoustic flooring, split air conditioning, internal laundry
- Proximity to Centennial Park, Kensington/Randwick villages, and the CBD
- Convenient bus service to the city and beaches; near university campuses

Price:

SOLD



**Li (sammi) Fan**

0415 959 888

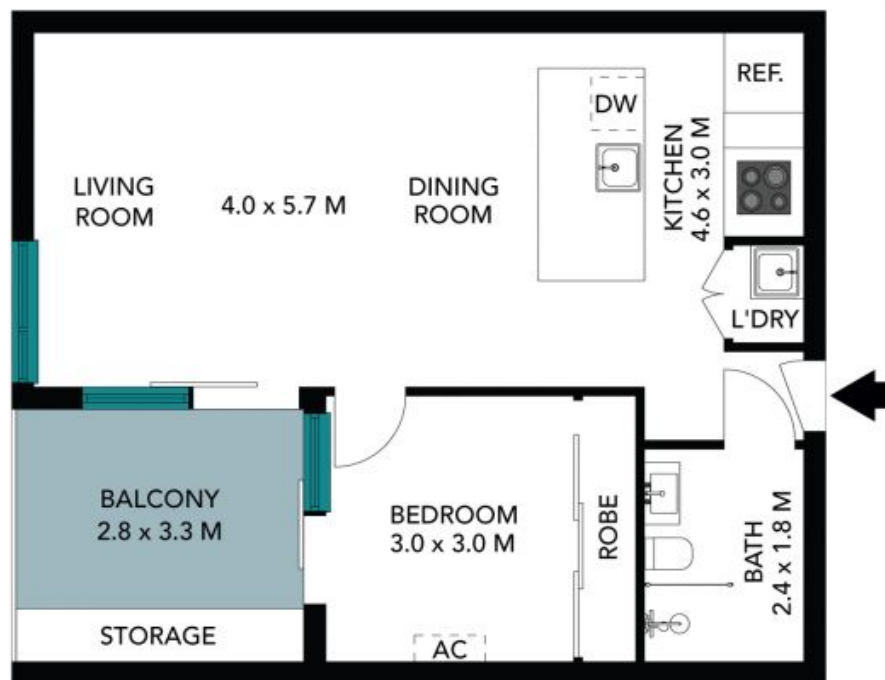

The floor plan is not to scale, measurements are indicative and in metres. Station elements are not in position. Plans should not be relied on. Interested parties should make and rely on their own enquiries. All other information provided has been collected from reliable sources but cannot be guaranteed for accuracy.

304/132 Epsom Road  
Zetland

STONE

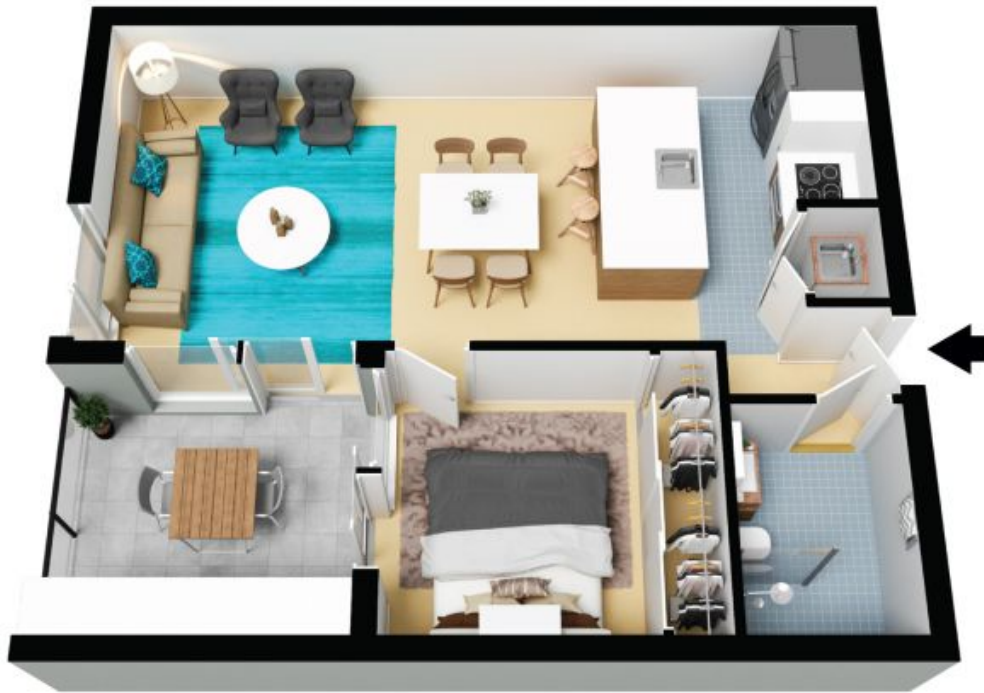

The floor plan is not to scale; measurements are indicative and in metres. All features included in this 3D plan are for inspiration purposes only. This is not an exact replica of the property or the position of exterior elements. Plans should not be relied on. Interested parties should make and rely on their own enquiries.