



326/51-54 The Esplanade Ettalong Beach, NSW



Water views over looking the resort pool

Positioned in a prime location opposite the beach with beautiful waterviews and in the heart of Ettalong beach is this fully furnished apartment. Positioned on level 3 with an east facing balcony overlooking the pool with views towards Wagstaffe and offering all the luxuries of resort style living this unit is an ideal getaway for yourself and your guests.

- Good size covered entertaining balcony to enjoy the view
- Fully furnished, separate bedroom with a large built-in wardrobe
- Separate internal laundry with washing machine and clothes dryer
- Kitchenette with small fridge, microwave oven, two burner cook top
- Sleeps four people with a sofa bed option in the living room
- Single entry door, positioned just one unit back from the front of the complex
- Undercover parking, lift access to apartment and common areas
- Resort pool, spa and large common sun deck, access to the beach

Price: \$530,000 - \$560,000
Council Rates: \$1,110.52/year (approx)
Water Rates: \$912.89/year (approx)
Strata Rates: \$1,309.00 p/q



Christel Renton

0417 208 314



Helen Hughes

0418 220 622

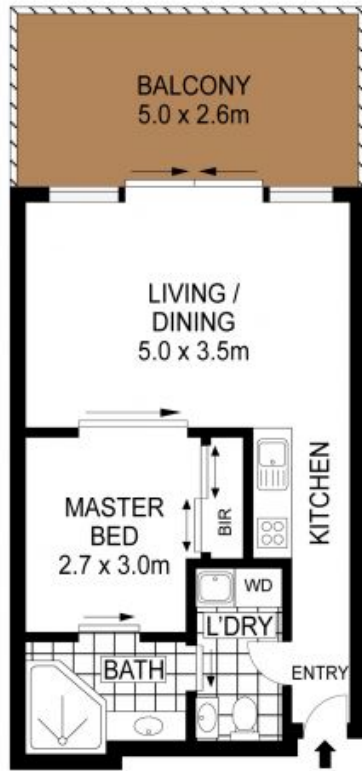

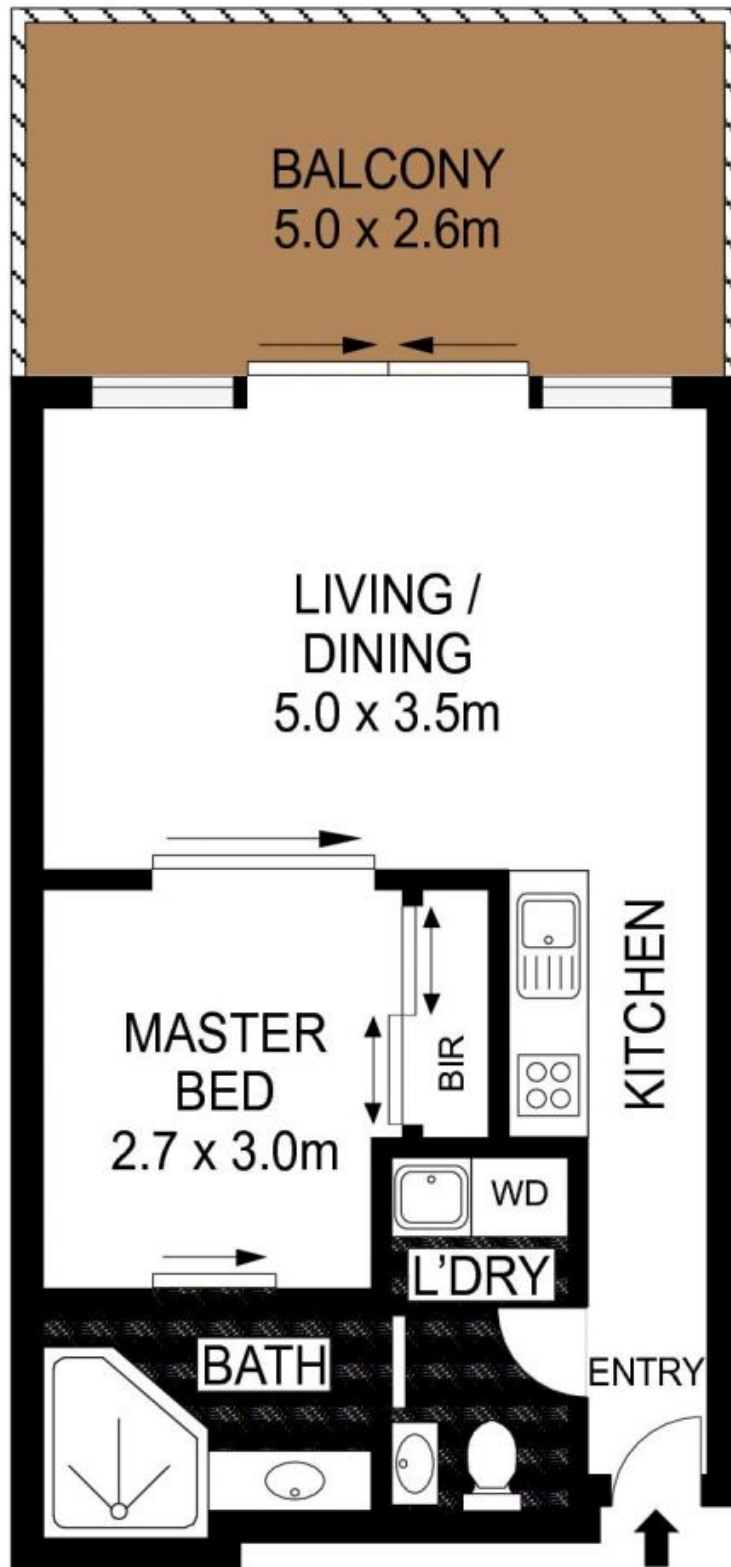

The floor plan is not to scale, measurements are indicative and in metres. Exterior elements are not in position. Plans should not be relied on. Interested parties should make and rely on their own enquiries. All other information provided has been collected from reliable sources but cannot be guaranteed of accuracy.