



22 Hartford Avenue Glen Alpine, NSW

4 2 2

Exceptional home by the golf course

Perfectly designed for growing families, this spacious and versatile home embodies convenience and family-oriented living.

Unveiling freshly updated interiors, a practical kitchen that seamlessly integrates with spacious living and dining areas, complimented by an outdoor oasis perfectly suited to help you unwind at home.

With its generous living areas, good size bedrooms, and inviting outdoor spaces, this home meets the diverse needs of different family dynamics, making it a perfect choice for creating lasting memories together.

Features:

- > Air conditioning on both floors ensures year-round climate control
- > A large backyard with a luxurious spa and landscaped gardens
- > A secure garage with space for two vehicles and additional room for tools

...

This unique blend of luxurious comfort and effortless convenience makes it a standout choice...

Price: \$950,000 - \$1,050,000

Council Rates: \$487.50 p/q



Troy Nicholson

0438 801 234



Mark Bricknell

0438 801 234

22 Hartford Avenue
Glen Alpine

STONE



(NOT IN POSITION)

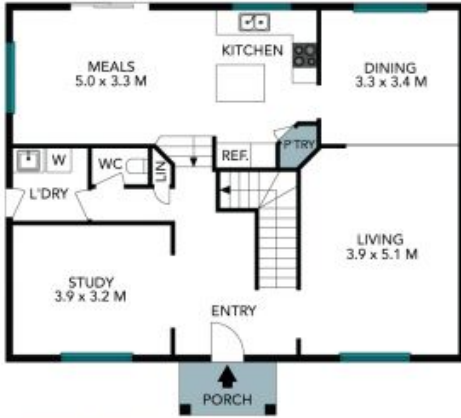

Ground Floor



First Floor



The floor plan is not to scale, measurements are indicative and in metres. Certain elements are not in position. Plans should not be relied on. Interested parties should make and rely on their own enquiries. All other information provided has been collected from reliable sources but cannot be guaranteed for accuracy.

22 Hartford Avenue
Glen Alpine

STONE



Ground Floor



First Floor



The floor plan is not to scale; measurements are indicative and in metres. All features included in this 3D plan are for inspiration purposes only. This is not an exact replica of the property or the position of exterior elements. Plans should not be relied on. Interested parties should make and rely on their own enquiries.