



Artist's Impression



1/11 Greyleigh Street Horsley, NSW

3 2 1

Single level designer living

Now complete - ready to occupy

Be the first to call this breathtaking designer duplex home. Inspired to offer a high standard of contemporary living with an emphasis on style, space and convenience. This Torrens Titled duplex impresses with a private aspect plus an array of luxurious finishes and second living/media room.

Spreading across a spacious single level layout, it promises comfortable family living and effortless entertaining. Minutes drive to Dapto shopping district, local schools and Kembla Grange pristine golf course.

- Positioned in the popular Fair Views Estate, ideal for the first homeowner, downsizer or investor
- Open plan living spaces plus excellent outdoor flow to entertaining alfresco courtyard area
- Premium kitchen complete with a CaesarStone island bench and sleek gas cooktop

Inspect: Saturday, 21st September 2024 9:00 - 9:30

Price: Price Guide \$800,000



Paul Piacentin

0411 754 884



Aaron Dean

0450 514 474

11 Greyleigh Street
Horsley

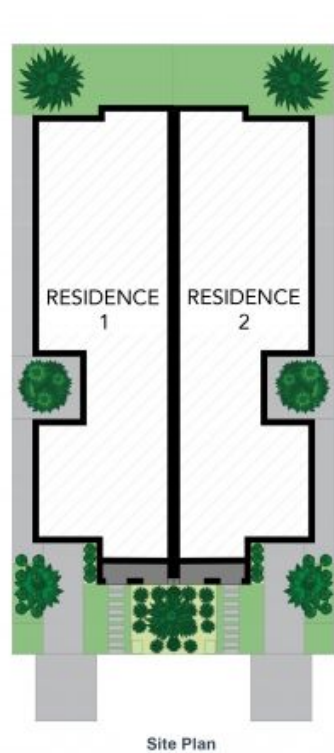
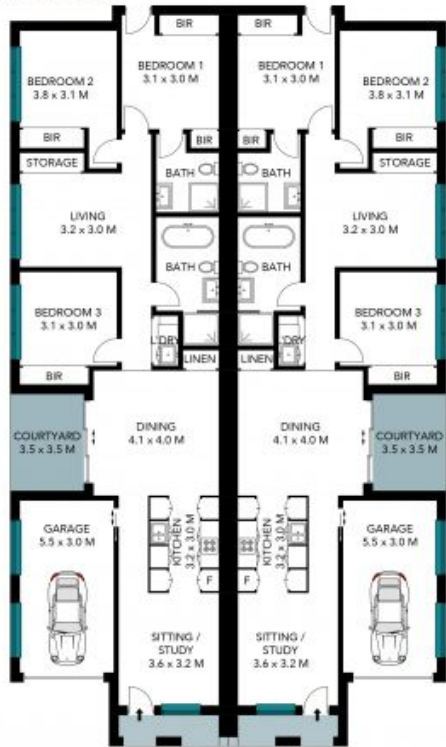

STONE

Site Plan



The site plan and floor plan are not to scale; measurements are indicative and in metres. Bushes and trees are placed for illustration purposes. Plans should not be relied on. Interested parties should make and rely on their own enquiries. All other information provided has been collected from reliable sources but cannot be guaranteed for accuracy.