



20/2 Pipeclay Street Lawson, ACT

2

2

1

Contemporary two-bedroom townhouse.

Auction date to be confirmed, please contact Hugo Mendez on 0421 349 916 or hugomendez@stonerealestate.com.au

Experience the epitome of modern living in the coveted suburb of Lawson with this exceptional two-bedroom townhouse at 20/2 Pipeclay Street, tailored for first home buyers and investors alike. This residence offers a unique blend of seclusion and convenience, tucked away in a peaceful development only moments from the vibrant heart of Belconnen.

Outside, discover a private west-facing courtyard, ideal for intimate gatherings or a quiet retreat. The convenience of an oversized single car garage with internal access and NBN readiness underscores the thoughtful design of this home.

...

Vacant and ready to move straight in....

Extra ground floor toilet....

A short distance to Maribyrnong Primary School, Kaleen High School, Radford College, Unive...

Price:

By Negotiation



Hugo Mendez

0421 349 916



First Floor

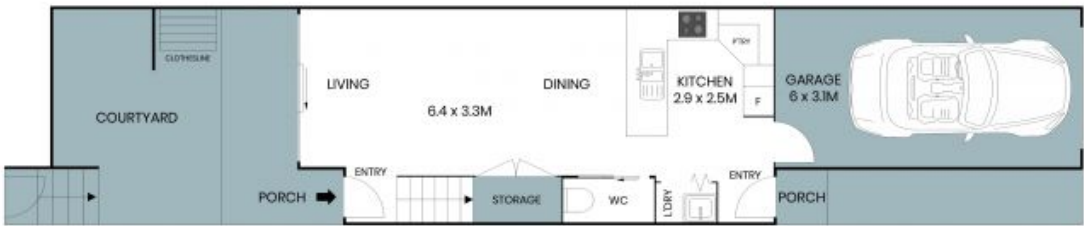

Ground Floor



The site plan and floor plan are not to scale; measurements are indicative and in metres. Bushes and trees are placed for illustration purposes. Plans should not be relied on. Interested parties should make and rely on their own enquiries. All other information provided has been collected from reliable sources but cannot be guaranteed for accuracy.



First Floor



Ground Floor



The floor plan is not to scale; measurements are indicative and in metres. All features included in this 3D plan are for inspiration purposes only. This is not an exact replica of the property or the position of exterior elements. Plans should not be relied on. Interested parties should make and rely on their own enquiries.