



7/5036 Emerald Island Drive Carrara, QLD

3 2 2

Bargain waterfront living

The 5036 Emerald Island Drive estate is located at the most eastern end of Emerald Island drive which is home to some of the finest owner-occupied residences within Carrara and the central Gold Coast. This estate is perfect for those looking for low maintenance living.

- Stunning wide water views
- King sized master bedroom has soaring high ceilings, ensuite and large robe.
- Split system heating and cooling on both levels for all year-round comfort.
- Large Caesar stone topped kitchen with sleek cabinetry.
- Ground floor laundry with generous under stair storage area.
- Pet friendly.

Strata rates: \$715pq approx.
Council rate: \$2,300pa approx.

Price: \$750,000



Scott Campbell

0400 768 805



Paige Algie

0416 579 380

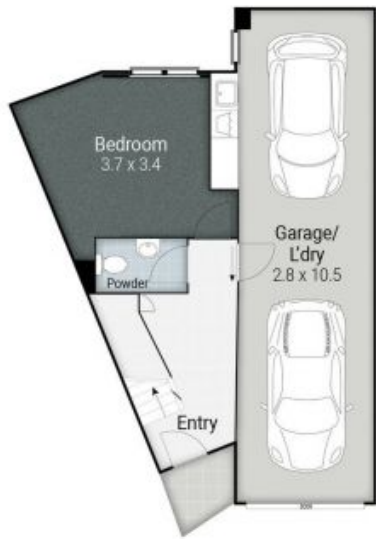

Ground Floor

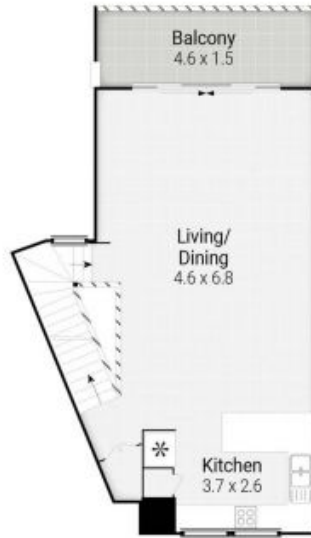

First Floor



Second Floor