



540 Wallan Road Whittlesea, VIC

4

2

10

Equine Bliss on 33 acres

Nestled on 33 acres of pure bliss, this haven is a dream come true for those seeking a serene and idyllic lifestyle. What sets this property apart are the two charming dwellings that stand as a testament to the memories and stories shared within their walls. Each one exudes its own character, offering a warm embrace to all those who enter. Whether its cosy family gatherings or heartfelt conversations with loved ones, these homes have witnessed countless moments of joy and love.

For those with a passion for equestrian pursuits, you'll be delighted to discover the concrete stables and tack room that await your equine companions. This sturdy structure stands as a testament to the dedication and care that has been poured into this property.

Features:

- 33 acres

Price: \$1,700,000



Dean Zammit

0405 140 704



Shenea Barclay

0418 832 981

540 Wallan Road
Whittlesea

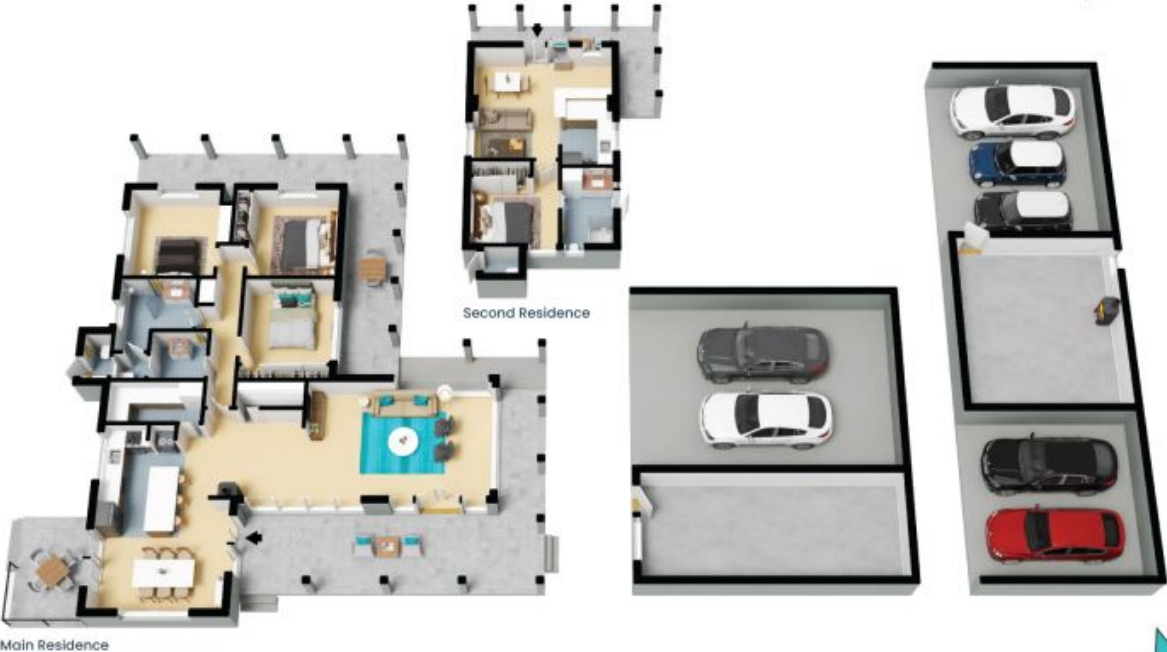

Main Residence

Second Residence



The floor plan is not to scale; measurements are indicative and in metres. All features included in this 3D plan are for inspiration purposes only. This is not an exact replica of the property or the position of exterior elements. Plans should not be relied on. Interested parties should make and rely on their own enquiries.

540 Wallan Road
Whittlesea



STONE

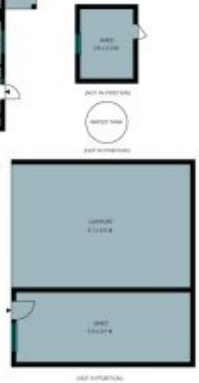
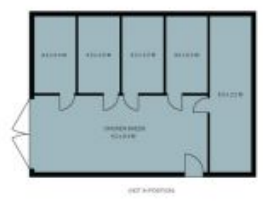

The site plan and floor plan are not to scale; measurements are indicative and in metres. Bushes and trees are placed for illustration purposes. Plans should not be relied on. Interested parties should make and rely on their own enquiries. All other information provided has been collected from reliable sources but cannot be guaranteed for accuracy.