



88 Lantana Road Engadine, NSW

2

1

1

Charming family cottage exudes warmth and comfort

Positioned on a 575.4sqm (approx.) block, this charming cottage is an enticing opportunity for owner-occupiers and investors alike. It offers a wonderful sense of warmth and comfort from a sunny north west facing aspect, along with providing effortless indoor/outdoor living in a family-friendly setting. The property is a walk from buses, cafes and Lantana Road Reserve, while minutes to Engadine Town Square.

- Combined lounge and dining zone features large windows to capture natural light
- Crisp white interior showcase original timber floorboards and high ceilings
- Spacious block provides child-friendly yards and undercover entertainers' porch
- Gas equipped kitchen fitted with stainless steel appliances and timber benches
- Two comfortable bedrooms, family bathroom presents separate shower and bathtub
- Established gardens and lawns, rain water tank, ceiling fans, kids cubby house
- Drive through access to backyard and oversized lock-up garage/workshop/storage
- Close proximity to Engadine Public School, Engadine High School and the station

Price: \$1,100,000

Council Rates: \$400.00 p/q

Water Rates: \$160.00 p/q



Rhys Christofa

0415 684 877



Brayden Watson

0415 122 733

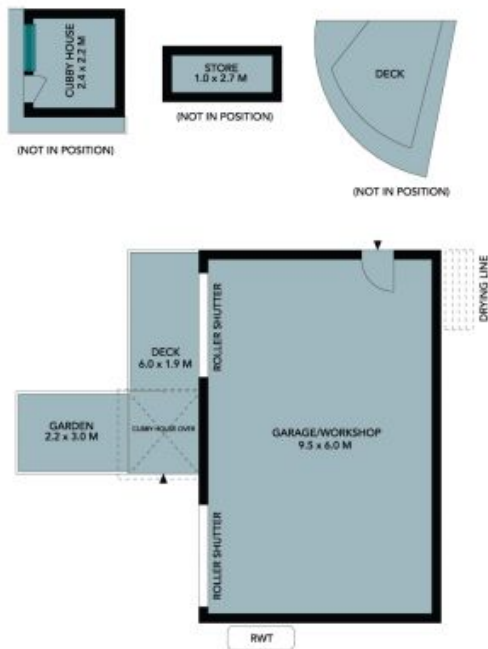

Site Plan

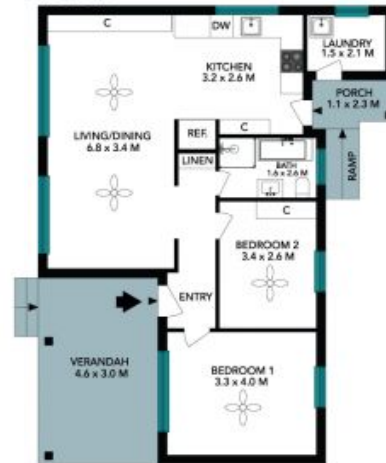

The site plan and floor plan are not to scale; measurements are indicative and in metres. Bushes and trees are placed for illustration purposes. Plans should not be relied on. Interested parties should make and rely on their own enquiries. All other information provided has been collected from reliable sources but cannot be guaranteed for accuracy.

88 Lantana Road
Engadine



The floor plan is not to scale, measurements are indicative and in metres. All features included in this 3D plan are for inspiration purposes only. This is not an exact replica of the property or the position of exterior elements. Plans should not be relied on. Interested parties should make and rely on their own enquiries.