



3 Kent Place Heathcote, NSW

4 

2 

2 

## Charming family retreat delivers peace and comfort

Situated privately on a quiet cul-de-sac, this lovingly maintained residence presents a tranquil indoor/outdoor environment steeped in lush established gardens. Offering fantastic opportunity to renovate with modern updates, it provides a flowing two storey layout that comprises generously sized interiors with an abundance of natural light. It is set only moments from bush tracks and local shops.

- Set on a 575.4sqm parcel, perfect as an entry-level home for growing families
- Separate living and dining zones flow to alfresco verandah overlooking backyard
- Neat and tidy kitchen complete with quality appliances and plentiful storage
- Four spacious bedrooms, versatile downstairs retreat with private outdoor access
- Fully equipped main bathroom, plus additional updated bathroom and outdoor w/c
- Split system air conditioning, original fireplace and period features throughout
- Complete with a single carport plus ample driveway and on street parking
- Close proximity to Heathcote Station, Engadine village and Royal National Park

**Price:**

Contact agent

**Water Rates:**

\$215.99 p/q



**Rhys Christofa**

0415 684 877



**Lisa Hale**

0417 418 250



3 Kent Place  
Heathcote

STONE

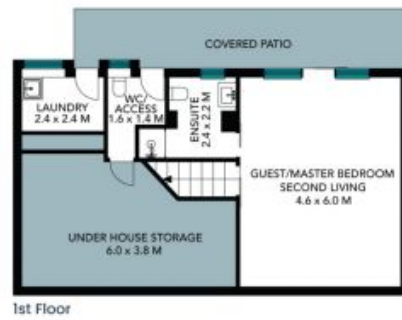

The site plan and floor plan are not to scale; measurements are indicative and in metres. Bushes and trees are placed for illustration purposes. Plans should not be relied on. Interested parties should make and rely on their own enquiries. All other information provided has been collected from reliable sources but cannot be guaranteed for accuracy.



Ground Floor



1st Floor



The floor plan is not to scale; measurements are indicative and in metres. All features included in this 3D plan are for inspiration purposes only. This is not an exact replica of the property or the position of exterior elements. Plans should not be relied on. Interested parties should make and rely on their own enquiries.