



48 Brae Street Wavell Heights, QLD

4

3

2

City views and Kedron State School catchment!

You read right! Kedron State School catchment - in Wavell! Boasting city views and a charming street presence that will make you feel like you've escaped to San Francisco every night, this immaculately kept home boasts 2 levels of living, heaps of yard space and a rare position that so many covet.

- City + Mt Coot-tha views
- Rich timber flooring
- Air-conditioning
- Quality kitchen appliances
- Huge entertaining possibilities
- Kedron State School catchment (one of only 4 streets)
- Walking + bike tracks close by
- Family friendly location

Price: Offers over \$1,150,000

Council Rates: \$734.20 p/q



Tristan Rowland

0411 572 970

Internal: 260 SQM
External: 72 SQM
Total Area: 332 SQM

Level 2



Level 1

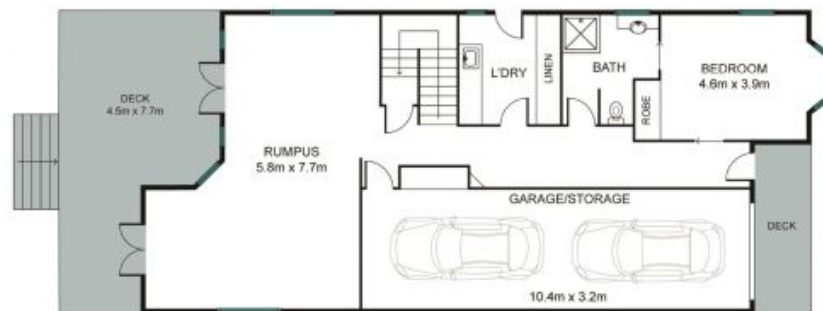

The site plan and floorplan are not to scale, measurements are indicative and in metres. Bushes and trees are placed for illustration purposes. Plans should not be relied on. Interested parties should make and rely on their own enquiries.

48 Brae Street, Wavell Heights

Stoneaspley.com.au

