

68 Kent Street Epping, NSW

3

1

2

Perfect Start - Premium Location Appx 1.1km walk to Epping Station.

Peacefully set in a private leafy and perfect location, this single level brick family home is neatly presented and boasts light-filled interiors with high ornate ceilings. Within 1.1kms easy walking distance to Epping station, all amenities and set on approx. 765sqm with 17.2m frontage. This lovely home presents an outstanding opportunity to purchase in a highly sought-after one of most desired locale .

- * Spacious combined lounge & dining room with large windows
- * High ornate patterned ceilings with timber flooring throughout
- * West & East aspect drenches the home in sunlight morning and afternoon
- * Generous neat kitchen with casual meals area
- * Three well-sized generous bedrooms
- * Original bathroom with separate shower, bath and toilet
- * Internal laundry
- * Single lock-up garage with storage plus carport
- * Large & sunny private back yard, great for family for outdoor entertainment Heights Public school....

Price:

Sold \$1,680,000



James Kwon

0414 988 891

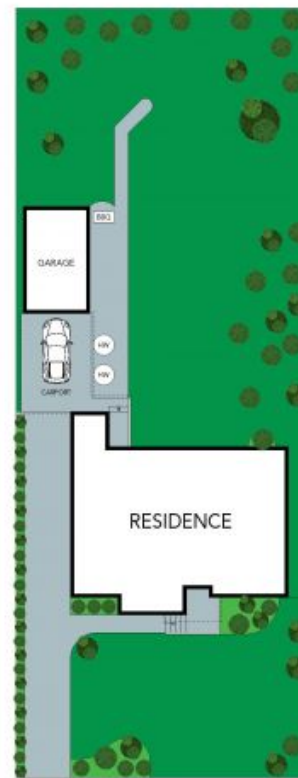

SITE PLAN

The floor plan is not to scale; measurements are indicative and in metres. Exterior elements are not in position. Plans should not be relied on. Interested parties should make and rely on their own enquiries.

68 Kent Street, Epping



STONE