

615/22 Charles Street Parramatta, NSW 2 2 1

Please contact Aaron Lih on 0420 825 598 to arrange a private inspection

Price: \$649,950

Interact with us:
STYLE THIS PROPERTY - <https://cdn.diakrit.com/product/styling/9786441>
FURNISH THIS PROPERTY - <https://cdn.diakrit.com/product/furnish/9786438>

Modern split level apartment situated in the heart of Parramatta CBD, with cafes, bars, restaurants, train station and Westfield Shopping town just footsteps away. Offering a bedroom and bathroom to each level plus a generous open plan lounge and dining area leading to a covered entertainer's balcony.

- Ultra sleek gas kitchen with island bench top and stainless steel appliances
- Private master bedroom with built in wardrobe, ensuite and balcony
- Second bedroom offering built in wardrobe and balcony
- Modern bathrooms with bathtub to main
- Split system air-conditioning, video intercom
- Secure basement parking with lift access



Aaron Lih
0420 825 598



Adam Denina
0413 546 713

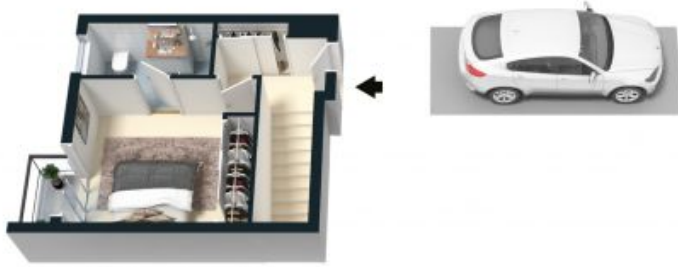

GROUND FLOOR



FIRST FLOOR

The floor plan is not to scale, measurements are indicative and in metres. All features included in this 3D plan are for inspiration purposes only. This is not an exact replica of the property or the position of exterior elements. Plans should not be relied on. Interested parties should make and rely on their own enquiries.



615/22 Charles Street, Parramatta



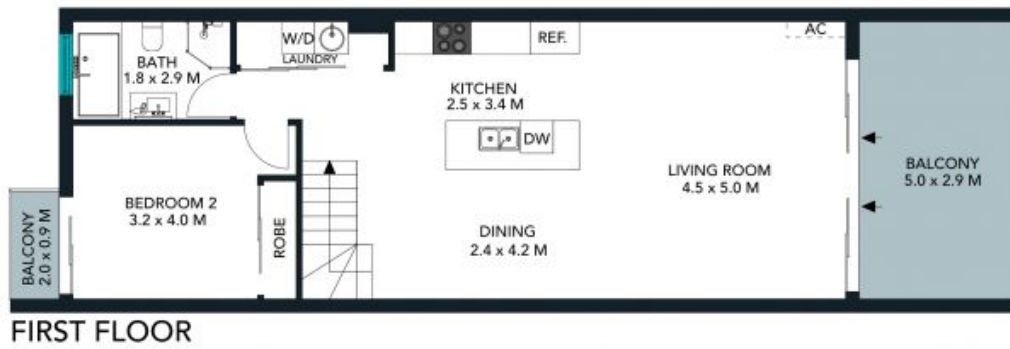
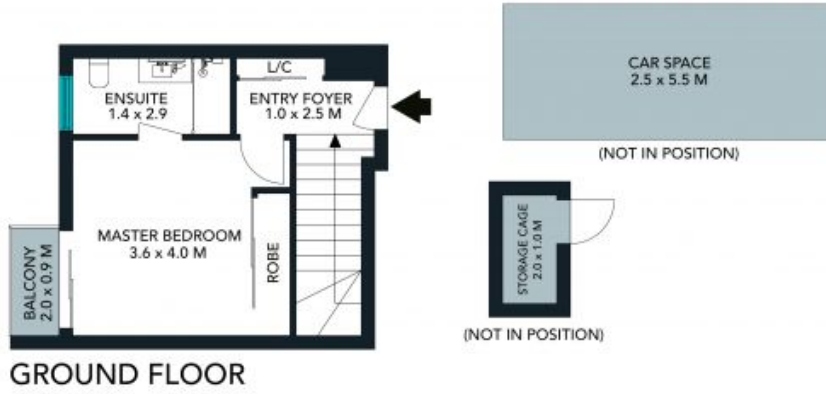

The floor plan is not to scale, measurements are indicative and in metres. Colour elements are not to position. Plans should not be relied on. Interested parties should make and rely on their own enquiries. All other information provided has been collected from reliable sources but cannot be guaranteed for accuracy.



615/22 Charles Street, Parramatta

